

SOGANI MAHILA MAHAVIDYALAYA

VILLAGE -RAWASA TEHSIL-BONLI

DISTT. - SAWAI MADHOPUR (RAJ.)

KHASARA NO. 19/1 TOTAL LAND AREA -17500 Sq.m.

CONVERTED LAND AREA 7200 Sq.m. SIZE W-80M L-90M

BUILT UP AREA 857.20 Sq.m.

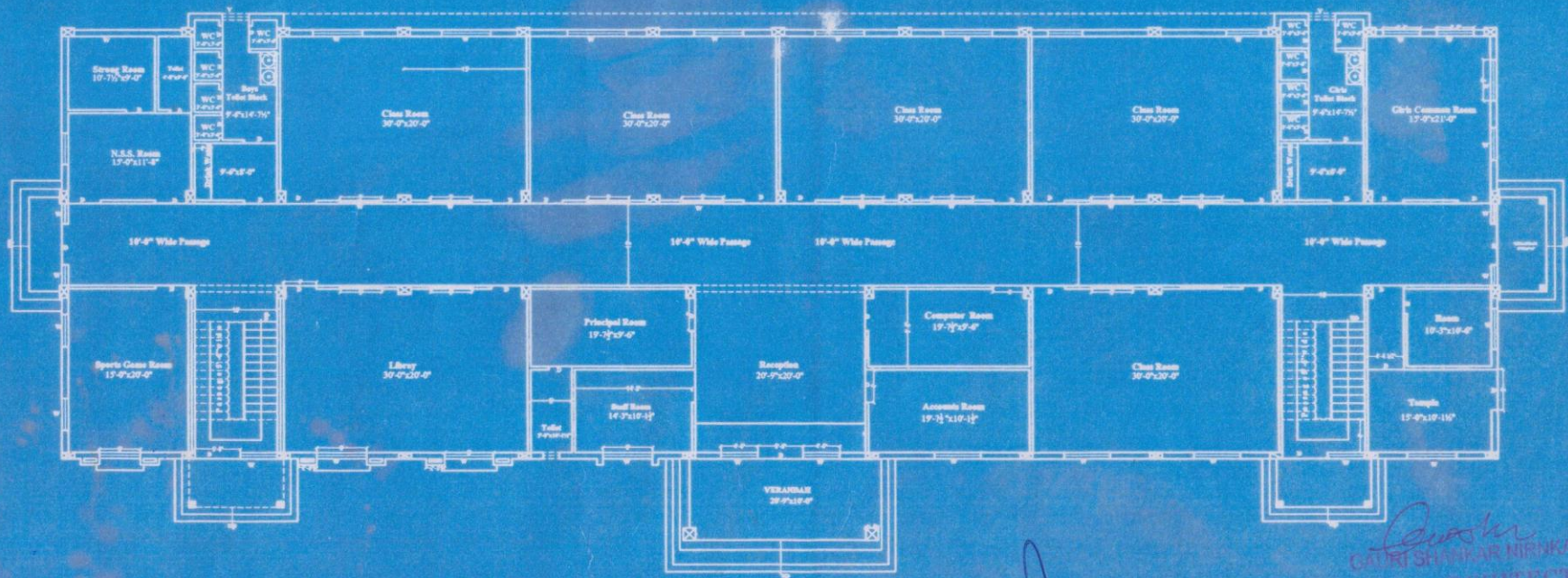

Shankar
SHANKAR NIRMAL
ERTA ARCHITECT
20, Rajgurunagar, Durgam
Chowk, Sec-10, Jaipur-302002
Regd. - SBI/14210R/P 16/03

20/03
सहायक अभियन्ता पायत. समिति वॉली
पंचायत समिति वॉली